

QUICKDRAW™

2L FILTER SYSTEM & 3L GRAVITY FILTER SYSTEM

CONTENTS

3L GRAVITY FILTER SYSTEM



2L FILTER SYSTEM



FILTER & HOSE

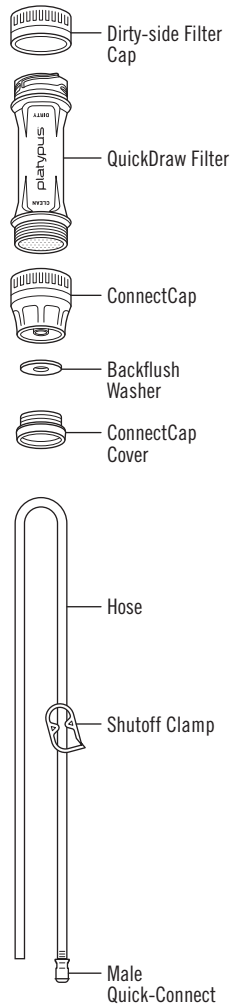

INTRODUCTION

Congratulations on your purchase of a QuickDraw™ Filter System. Out of the box, you have everything you need to start safely filtering water. The QuickDraw System was designed to be multi-compatible with many different bottles and reservoirs, allowing you to easily adapt the system to fit your needs.

This document is intended to teach you to properly use and care for your QuickDraw Filter System and provide important information on hollow fiber filtration, so you get the best filtering experience with any QuickDraw setup you create.

⚠ WARNING

BIOLOGICAL HAZARD

There are hazards associated with backcountry travel and the use of water filters. Drinking untreated water may expose you to harmful microorganisms and increase your risk of gastrointestinal illness. Using this filter improperly increases your risk of exposure to harmful microorganisms and increases your risk of gastrointestinal illness. Reduce your chances of becoming sick by following the warnings and instructions in this manual and educating yourself on backcountry water safety.

YOU ARE RESPONSIBLE FOR YOUR OWN SAFETY AND THE SAFETY OF THOSE IN YOUR GROUP. PLEASE USE GOOD JUDGEMENT.

Never use the QuickDraw to filter seawater or chemically contaminated water, such as water from mining tailing ponds or near large agricultural operations. The QuickDraw does not make drinkable water from these sources and does not remove all viruses, chemicals and radioactive materials, or particles smaller than 0.2 Microns.

Keep the Dirty reservoir and Dirty-side cap and other potentially contaminated parts away from filtered water to prevent cross-contamination.

READ, UNDERSTAND AND FOLLOW ALL instructions and warnings in this manual before using this filter. Failure to follow the warnings and instructions may result in gastrointestinal illness.

IMPORTANT

Read and understand this entire manual carefully before assembling or using this water filter. Improper use of the filter may void the warranty and result in gastrointestinal illness. Keep this manual for future reference. If you do not understand this manual or have any questions, please call Cascade Designs at 1-800-531-9531.

⚠ WARNING

Do not drop or freeze the QuickDraw Filter. A damaged filter cannot prevent exposure to harmful microorganisms. If you suspect the cartridge may be damaged, perform an integrity check (see **Integrity Check**). If the cartridge is damaged, discontinue use and replace it.

⚠ WARNING

If the spout becomes contaminated with dirty water, disinfect it (see **Long-Term Storage**) before filtering your water or drinking from the spout.

FIRST STEPS: WETTING OUT THE FILTER

For optimal performance, fully wet out the filter before use in the field by filtering at least 1L of clean water through it.

- For setup and use instructions, see **Using the QuickDraw**.
- For more on wetting out the filter, see **Air Management**.

USING THE QUICKDRAW

WATER COLLECTION

Filling

1. [3L Gravity System only] Ensure the handle to the Dirty reservoir is attached. If not, push the posts through the handle's wide slots, then pull the handle so the posts are secured in the narrow portion of the slots. (Fig. 1)
2. Fill the reservoir. If necessary, replace the reservoir cap for transport. (Fig. 2)

(Fig. 1)

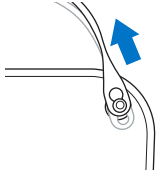

(Fig. 2)

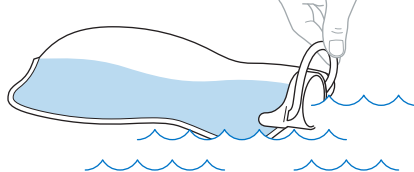

Tips:

- Always collect the cleanest, clearest water source available. Moving water is better than still water.
- Filtering silty, cloudy, muddy, glacial, or tea-colored water can clog the filter faster. Frequently clean and flush your filter for best performance (see **Cleaning**).
- When filling the QuickDraw Reservoir or dirty vessel, take care to keep the clean side of your filter, the clean side cap(s), and any clean bottles or reservoirs safely away from unfiltered water to prevent any possible contamination.

ASSEMBLE THE SYSTEM

Initial Setup

1. Remove the Dirty-side cap from the filter and safely set it aside.
2. Remove the cap of the full Dirty reservoir.
3. Attach the Dirty side of the filter to the Dirty reservoir. (Fig. 3)
4. Remove ConnectCap cover.

At this point you are ready to filter. To filter into an attached Clean bottle or reservoir, see the following instructions for your preferred clean receptacle.

(Fig. 3)

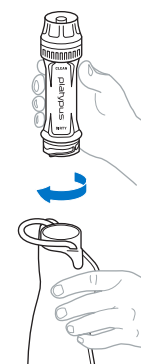

Attaching to Clean Bottles

- The threads of the ConnectCap will accept all narrow-mouth Platypus® bottles and common 28mm plastic bottles like smartwater®. (Fig. 4)
- [3L Gravity System only] If you want to filter into a wide-mouth bottle, use the hose and bottle adapter. Attach the hose to the QuickDraw and press the male quick-connect into the top of the bottle adapter. (Fig. 5)

Attach the bottle adapter to your wide-mouth or narrow-mouth clean bottle.

Narrow-mouth bottles press-fit into place; (Fig. 6a) wide-mouth bottles screw into the inner or outer threads. (Fig. 6b)

(Fig. 4)

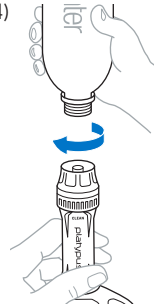

(Fig. 5)

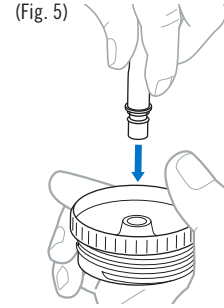

(Fig. 6a)

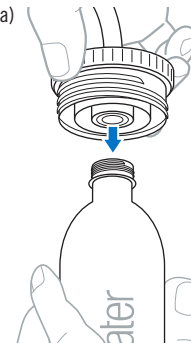

(Fig. 6b)

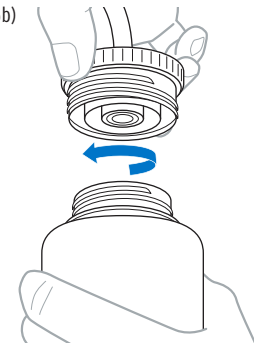

Attaching to Clean Hydration Reservoirs

1. Attach the hose to the QuickDraw by pushing the end of the hose without the quick-connect fitting securely on to the hose attachment point inside the ConnectCap. (Fig. 7)
2. Pinch the hose shutoff clamp to ensure water doesn't flow through before you are ready. (Fig. 8)
3. The male quick-connect will click into any reservoir with a compatible female quick-disconnect, such as the Platypus Big Zip™ Evo. (Fig. 9)

(Fig. 7)

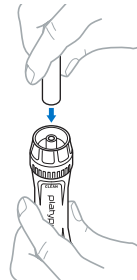

(Fig. 8)

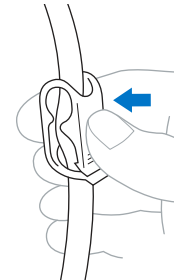

(Fig. 9)

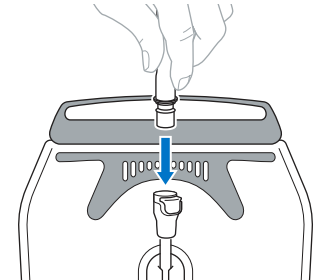

FILTERING

Gravity Filtering (QuickDraw 3L Gravity System) (Fig. 10)

1. Hang your Dirty reservoir or set it on a surface that is elevated above your clean bottle or reservoir.
2. Unclamp the hose shutoff clamp to allow water to flow.
3. Pinch the shutoff clamp to stop the flow of water when desired amount of water has been filtered.

Note: Both the ConnectCap and the bottle adapter have built-in vents (see **Air Management** for more info). THIS MEANS THAT THEY WILL BEGIN TO LEAK ONCE AN ATTACHED BOTTLE REACHES CAPACITY. If you are using this setup, be sure to monitor your filter to avoid leaking.

Squeeze Filtering (QuickDraw 2L System & 3L Gravity System) (Fig. 11)

1. Invert the Dirty reservoir over the attached filter.
2. Squeeze the reservoir with consistent pressure to push the water through the filter until the reservoir is empty or you have filtered the desired volume of water. Slowly rolling the top of the reservoir down is an effective way of squeezing the water through the filter.

(Fig. 10)

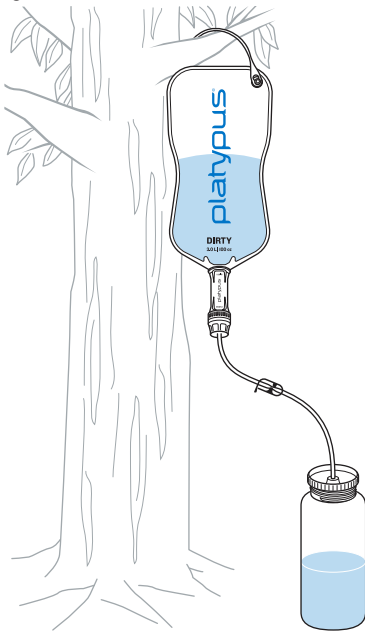

(Fig. 11)

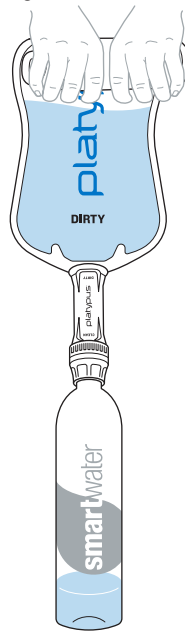

AIR MANAGEMENT

Air is one of the primary causes of a clogged filter or slow filtration rates. Properly managing air will help maintain the best performance.

Wetting Out the Filter

Wetting out the filter is the process of purging air from the hollow fibers and replacing it with water. Air and water cannot occupy the same space, and trapped air will slow flow rates. The amount of water that it takes to properly wet out the filter is typically 1L, though up to 4L may be needed.

Air & the Integrity Check

When intact and wetted out, the QuickDraw's hollow fibers will not let air pass through from the Dirty side to the Clean side. The integrity check is the attempt to force air through the hollow fibers from the Dirty side to the Clean side. A steady stream of bubbles means air is passing through and indicates broken fibers. Note that air can enter the clean side of intact fibers. When performing an integrity check, do not mistake purging a small amount of air as a 'steady stream of bubbles'. Wetting out the filter before an integrity check is a good practice to avoid uncertainty.

Air & Hard-Sided Clean Bottles

An empty hard-sided bottle like a Nalgene® is full of air. In a sealed system, this air needs to be able to escape for water to flow into the bottle. To make filtering into hard-sided bottles possible, the ConnectCap and bottle adapter were designed with vents to allow air to escape.

INTEGRITY CHECK

If the QuickDraw filter is dropped or if water freezes inside of it, the hollow fibers can rupture and will not safely filter water. If you are concerned this has happened, check if the filter is still safe to use with the following method:

1. Fill your Dirty reservoir with 1L of water and attach it to the Dirty side of the filter.
2. Filter approximately half of the water through the filter.
3. Flip reservoir upside-down so the filter is above the reservoir and the bottom of the filter (Dirty side) is in contact with the air inside.
4. Remove the ConnectCap. (Fig. 12)
5. Squeeze firmly on the bag for 20 seconds to push air up through filter.
6. During those 20 seconds, look for a steady stream of bubbles emerging from the hollow fibers on the clean side.
7. A steady stream of bubbles indicates the hollow fibers are compromised and the filter is NOT SAFE TO USE. (Fig. 13)

Note: It is important that the hollow fibers are fully wetted out to best perform the integrity check. (See **Air Management**)

(Fig. 12)

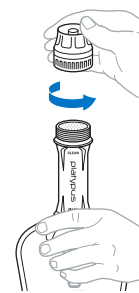

(Fig. 13)

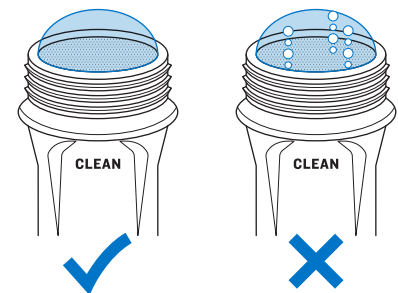

CLEANING THE FILTER

The best cleaning method is prevention. Proactively cleaning the filter will prolong its life and keep it flowing fast. The frequency of cleaning depends on the water quality, but good cleaning habits will make a difference in the long run.

- Perform a quick shake-to-clean before each fill-up.
- Backflush after approx. every 10L filtered.

Shake-to-Clean

The shake-to-clean method is the quickest way to clean the filter. It works by dislodging particulates stuck on the hollow fibers, particularly at the entrance on the dirty side.

1. Fill 1/2L of water in your Dirty bottle or reservoir.
2. Holding the filter and reservoir horizontally, shake vigorously for 15 seconds. (Fig. 14a) Then, holding them vertically so the filter is above the reservoir, shake vigorously for 15 seconds. (Fig. 14b)
3. Unscrew the filter and empty Dirty reservoir. Refill and resume filtering.

(Fig. 14a)

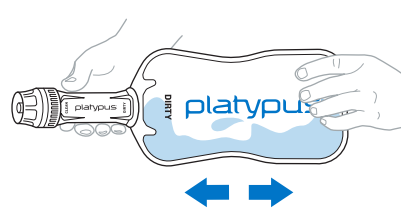

(Fig. 14b)

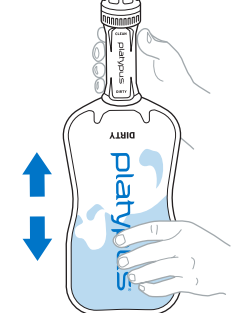

Backflushing

Backflushing is the most effective way to clean the filter. Backflushing requires clean water in your Clean reservoir or bottle and is done by reversing your system's direction of flow to send clean water back through your filter to purge the particulates clogging the hollow fibers.

- Backflush at least 1/2L of water or until water runs clear out of the Dirty side.

⚠ WARNING

Only backflush with a dedicated Clean bottle or reservoir to avoid cross-contamination.

Backflushing With the ConnectCap (Fig. 15b)

Note: This method requires the backflush washer.

1. If necessary, remove the ConnectCap cover. Press the backflush washer into the ConnectCap to block the vents and prevent leaking. (Fig. 15a)
2. Screw on a Clean narrow-mouth bottle filled with at least 1/2L of clean water.
3. Squeeze the bottle and backflush at least 1/2L of water or until water runs clear out of the Dirty side.
4. Remove washer from ConnectCap by tipping the filter over and shaking it out.

Tip: Take care not to lose the backflush washer—store it somewhere safe, like your first aid kit.

(Fig. 15a)

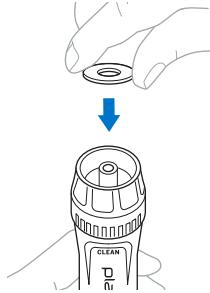

(Fig. 15b)



Backflushing With the Hose & Quick-connect (Fig. 16)

Backflushing with the Hose & Bottle Adapter (Fig. 17)

(Fig. 16)

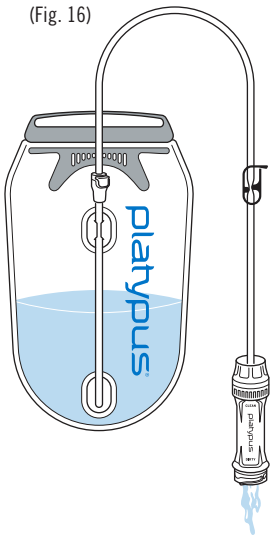

(Fig. 17)

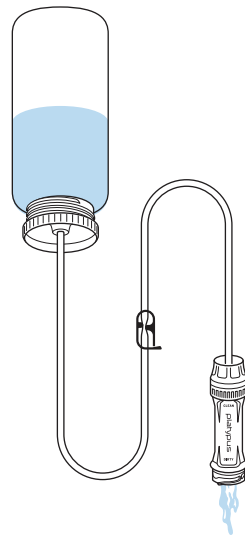

LONG-TERM STORAGE

Disinfecting the filter and reservoir before long-term storage will prevent potential growth of microorganisms in the cartridge.

1. In your Dirty reservoir or bottle mix 2.5mL (1/2 tsp) of bleach with 1L of tap water.
2. Attach the filter to the Dirty reservoir.
3. Filter the bleach solution through the filter (and hose if it was used).
4. When the reservoir is empty, detach the filter. Leave the reservoir cap off until the reservoir is fully dry.
5. Drain any excess water from the filter and replace the Dirty-side cap.
6. Dry the other components. When the reservoir is dry, replace the cap.
7. Store away from direct sunlight in a place where it won't freeze or be dropped.

Note: It is okay to store the filter with wet hollow fibers so long as it has been sterilized. The bleach solution will prevent the growth of microorganisms. A fully dry filter will protect it against freezing.

⚠ WARNING

Never store the QuickDraw filter in temperatures below 32F/0C. Freezing the filter will permanently damage the hollow fibers when there is water present.

⚠ WARNING

Never use a dishwasher to disinfect or clean the filter. High heat will melt or damage the hollow fibers.

LIMITED WARRANTY/LIMITATIONS OF REMEDIES AND LIABILITY

USA AND CANADA

Limited Warranty. Cascade Designs, Inc. ("Cascade"), to the original owner ("Owner"), under intended use and maintenance, warrants the enclosed product ("Product") to be free from defects in materials and workmanship for the life of the Product. No warranty against defects in materials and workmanship will apply if Product is (i) altered in any way, (ii) used for purposes inconsistent with Product's intended purpose or design, or (iii) improperly maintained. Warranty will furthermore be voided where Owner/user (i) failed to follow Product instructions or warnings or (ii) subjected Product to misuse, abuse, or neglect.

During the warranty period, original Product parts determined by Cascade to be defective in materials or workmanship will be repaired or replaced as Owner's sole remedy. Cascade reserves the right to replace any discontinued product with a new product of comparable value and function. A returned product deemed irreparable becomes the property of Cascade and will not be returned.

EXCLUDING THE LIMITED WARRANTY PROVIDED ABOVE, CASCADE, ITS AFFILIATES AND THEIR SUPPLIERS, TO THE MAXIMUM EXTENT PERMITTED BY LAW, MAKE NO WARRANTIES, EXPRESSED OR IMPLIED, AND DISCLAIM ALL WARRANTIES, DUTIES AND CONDITIONS, WHETHER EXPRESSED, IMPLIED OR STATUTORY, WITH RESPECT TO THE PRODUCT, INCLUDING WITHOUT LIMITATION ANY IMPLIED WARRANTIES OF MERCHANTABILITY, AGAINST LATENT DEFECTS, FITNESS FOR A PARTICULAR PURPOSE, OR CORRESPONDENCE TO DESCRIPTION.

Warranty Service. To obtain service under this warranty, the warranty-eligible Product must be presented to a Cascade authorized dealer. In the United States and Canada, warranty service may also be obtained by calling 1.800.531.9531 [M - F, 8:00 a.m. - 4:00 p.m., PDT]. Owner is responsible for all costs associated with returning Product to Cascade for service. Where at its sole discretion Cascade deems Product eligible for warranty repair or replacement, Cascade will pay the shipping and handling associated with returning repaired or replaced Product to Owner. In instances where Cascade deems a returned product ineligible for warranty service, Cascade will, if possible, repair product for a reasonable charge that includes return shipping and handling. For warranty return service details, please go to www.platy.com.

Limitation of Remedies. Should a court of competent jurisdiction find the limited warranty set forth above breached, Cascade's only obligation will be to, at its option, either repair or replace Product. Should the aforementioned remedy fail of its essential purpose, Cascade will, in exchange for return of Product, refund to Owner Product's original purchase price.

THE FOREGOING REMEDY IS THE SOLE AND EXCLUSIVE REMEDY OF THE PURCHASER AGAINST CASCADE, ITS AFFILIATES AND THEIR SUPPLIERS, REGARDLESS OF LEGAL THEORY.

Limitation of Liability. Cascade's, its affiliates' and their suppliers' maximum liability is limited to incidental damages not to exceed the original purchase price of the Product. CASCADE, ITS AFFILIATES AND THEIR SUPPLIERS HEREBY DISCLAIM AND EXCLUDE ANY LIABILITY FOR ANY CONSEQUENTIAL OR OTHER DAMAGES RESULTING FROM ANY REASON WHATSOEVER. THIS EXCLUSION AND LIMITATION APPLIES TO ALL LEGAL THEORIES UNDER WHICH DAMAGES MAY BE SOUGHT, AND WILL APPLY EVEN IF ANY REMEDY FAILS OF ITS ESSENTIAL PURPOSE.

This limited warranty gives Owner specific legal rights; Owner may have additional rights, which may vary state to state. Always completely follow safety, use, operation, and maintenance instructions for this or any other Cascade product. European Union customer statutory rights are not affected.

FOR PRODUCT SERVICE AND INFORMATION CONTACT:

Cascade Designs, Inc.

4000 First Avenue South, Seattle, WA 98134 USA | 1-800-531-9531

Cascade Designs, Ltd.

Dwyer Road, Midleton, County Cork, Ireland | (+353) 21-4621400

#34-350-1 | 11/23

www.platy.com